

DISHED END BLANK  
2-OFF PER TANK CONTAINER

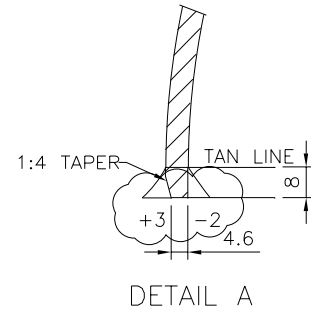

DETAIL A

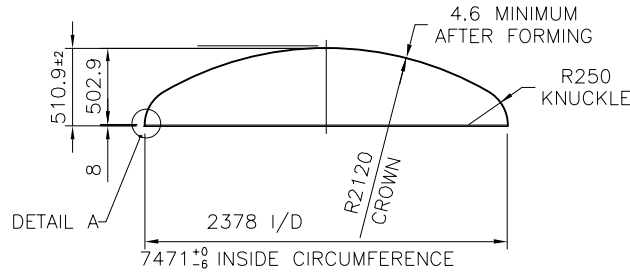

WELDING DETAIL  
LW1  
FULL PENETRATION

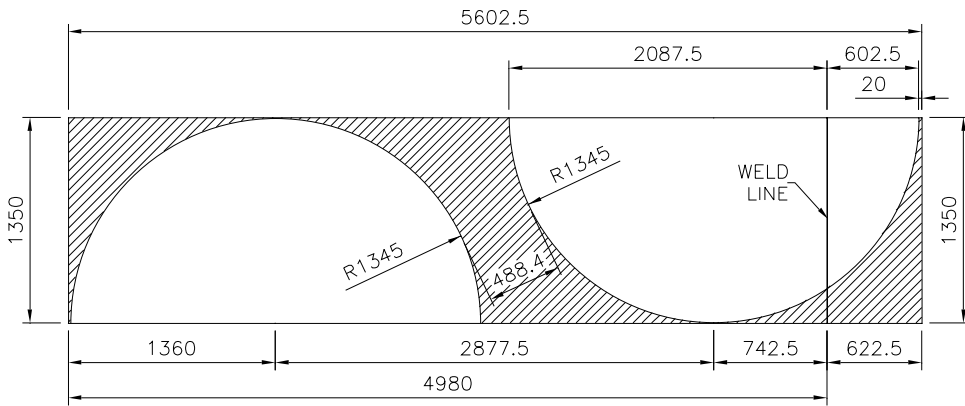

NESTING DIAGRAM

MATERIAL SPECIFICATION

W DIN 17440 W1.4406 C<0.03% (1985 EDITION)						
PARTS LIST						
No.	QTY	MAT	STOCK CODE	DESCRIPTION	DIMENSIONS	REFERENCE
1	2	W	2947	DISHED END PLATE	PLT 5.4x1350x4980	

DISHED END PLATE MINIMUM MECHANICAL PROPERTIES SPECIFICATION

0.2% PROOF STRESS @ 130°C => 245 MPa  
1.0% PROOF STRESS @ 20°C => 365 MPa  
1.0% PROOF STRESS @ 130°C => 270 MPa

U.T.S. @ 20°C => 630 MPa  
ELONGATION => 49%  
UTS x ELONGATION => 31 000

FINISH:

INTERNAL WELDS - POLISHED TO 180 GRIT  
(Ra=1.3µm MAX.)  
WELD SEAMS - GROUND FLUSH

NOTES

- QUANTITIES GIVEN ARE FOR 1-OFF T.C.  
50-OFF TANK CONTAINERS IN CONTRACT

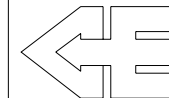

CONSANI ENGINEERING (PTY) LTD

ELSIES RIVER, CAPE TEL. 592-3400  
SOUTH AFRICA FAX. 591-2825

INTERMODAL CONTAINERS

THIS DRAWING AND INFORMATION IS THE PROPERTY OF CONSANI ENG. (PTY) LTD AND MAY NOT BE REVEALED TO ANY THIRD PARTY WITHOUT OUR WRITTEN PERMISSION.  
CAD: 24422063

TANK CONTAINERS  
25 000 LITRE IMO TYPE 1-4 BAR  
DISHED END DETAILS

REVISION B				REVISION A				DRAWING APPROVAL			NOMINAL DIMENSIONS (SHORT SIDE OF TRIANGLE)															
AUTHORITY	SIGN.	DATE	DESCRIPTION	AUTHORITY	SIGN.	DATE	DESCRIPTION	AUTHORITY	SIGNATURE	DATE	REQUIRED TOLERANCE	DEGREES & MINUTES			MM/M											
												ABOVE 0 TO 315	ABOVE 315 TO 1000	ABOVE 1000 TO 315	ABOVE 315 TO 1000	ABOVE 1000 TO 315	ABOVE 315 TO 1000	ABOVE 1000 TO 315	ABOVE 315 TO 1000	ABOVE 1000 TO 315	ABOVE 315 TO 1000	ABOVE 1000 TO 315	ABOVE 315 TO 1000			
DRAWN				DRAWN				DESIGN			A	± 20'	± 15'	± 10'	± 6'	± 4.5'	± 3'	± 1'	± 1'	± 2'	± 3'	± 4'	± 4'	± 6'		
DESIGN				DESIGN				QUALITY ASSURANCE			B	± 45'	± 30'	± 20'	± 13'	± 9'	± 6'	± 2'	± 2'	± 3'	± 4'	± 6'	± 8'	± 10'		
QUALITY ASSURANCE				QUALITY ASSURANCE				CONTRACTS			C	± 1'	± 45'	± 30'	± 18'	± 13'	± 9'	± 3'	± 4'	± 6'	± 8'	± 11'	± 14'	± 18'		
CONTRACTS				CONTRACTS				INSPECTION AUTHORITY			D	± 1'30'	± 1'15'	± 1'	± 26'	± 22'	± 18'	± 4'	± 7'	± 9'	± 12'	± 16'	± 21'	± 27'		
INSPECTION AUTHORITY				INSPECTION AUTHORITY				CLIENT			DIN 8570 PART 1 FROM 0-30 TOLERANCE ±1 DIN 8570 PART 3															

CLIENT	OCI	SCALE	1:25	DRAWING NUMBER		REVISION
WORKS ORDER	2442	DRAWN	RASHAAD	2442-02-2063		0
		CHECKED				
		DATE	13/02/02			